

Vertilux Motorization Systems - Roman Shades

TECHNICAL CATALOG FOR: MOTORIZATION SYSTEM

6-100-LW-25B83



Motor- 24v DC- 30 r.p.m., 0.8 Nm torque

PACKING UNIT: 1 piece

6-100-60-50000



Adjustable Mechanical Stop (Limit Switch)

PACKING UNIT: 1 piece

0-160-CA-04100

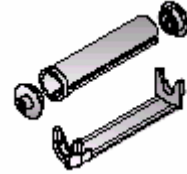

Toxa Cord Takeup System

PACKING UNIT: 1 set

6-100-60-50401 & 0-160-CA-04500

N/A

**Stop Collar Ring for 6mm (6-100-60-50401)
"O" Ring (0-160-CA-04500)**

PACKING UNIT: 1 piece

6-100-44-07100



Motor Support for Toxa Roman Shade System

PACKING UNIT: 1 piece

0-160-CA-02500



Toxa /Rodas Aluminum Tiltrod

PACKING UNIT: 30pcs at 16.4 ft 492 feet

6-100-63-00951

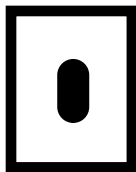

**5 position D/C Rocker Switch
(choose one control type)
(not required if motor is remote controlled
with infrared or radio remote control.)**

PACKING UNIT: 1 pcs per box